

# SitnStand

Portable Smart Rising Seats

## USER MANUAL

Exclusively distributed by



© 2022 **Life Assistant LTD**

Manual identification: LAPLAB.000.002-R11, Feb 2022

© 2022 **Life Assistant** Ltd, all rights reserved. No part of this manual may be reproduced in any form without the written permission of **Life Assistant** Ltd.

**Life Assistant** Ltd. reserves the right to change or improve its products and accompanying technical literature without specific notice to changes or improvements.



## Manufacture

### Life Assistant LTD,

8 Harod St.Afula, 1871208, ISRAEL

email [info@sitnstand.com](mailto:info@sitnstand.com)

web [www.lifeassistant.com](http://www.lifeassistant.com)



## Authorized Representative in the EU:

### Advena Ltd.

Malta Office  
Tower Business Centre, 2nd Flr,  
Tower Street, Swatar,  
BKR 4013, Malta

UK Office  
Pure Offices, Plato Close,  
Tachbrook Park, Warwick,  
CV34 6WE, UK



# TABLE OF CONTENTS

---

<b>INTRODUCTION.....</b>	<b>6</b>
About This Manual.....	7
Life Assistant Sitnstand Product Overview.....	7
Contents.....	8
Special messages: Warnings, Cautions and Notes.....	8
Conditions for Use.....	9
<b>SAFETY.....</b>	<b>10</b>
General Warnings and Cautions.....	11
<b>LABELS AND SYMBOLS.....</b>	<b>12</b>
<b>USING THE SITNSTAND.....</b>	<b>14</b>
Setup Instructions.....	15
Following the Appropriate Seat Selection.....	17
Controller indicators modes.....	19
Sitting Down.....	20
Standing Up.....	20
Replacing the Battery.....	21
Charging the Battery.....	21
<b>MAINTENANCE.....</b>	<b>22</b>
<b>TROUBLESHOOTING.....</b>	<b>24</b>
Basic Troubleshooting.....	25
To Obtain Information.....	27
<b>OPERATING SPECIFICATIONS.....</b>	<b>28</b>
Environmental.....	29
1.2. Electrical.....	30
1.3. Physical and Operational.....	31
<b>LIMITED WARRANTY.....</b>	<b>32</b>
<b>EMC STATEMENT.....</b>	<b>34</b>
Warnings.....	35
Electromagnetic Emissions.....	36

# INTRODUCTION

## ABOUT THIS MANUAL

This manual provides the information necessary to operate **Life Assistant SitnStand – Portable Smart Rising Seat** in a safe and efficient manner. Please review and understand this manual before operating the system. If any part of this manual is unclear, contact your supplier or **Life Assistant** Customer Support for clarification.

## Life Assistant Sitnstand Product Overview

**The SitnStand – Portable Smart Rising Seat** is a lightweight, portable inflatable system that is safe, simple and easy to operate. It comprises an electronic control system, multiple air valves, multiple air sealed layers, and a portable air pump that supplies the required pressure and air capacity to assist standing up and sitting down with minimum/no help required.

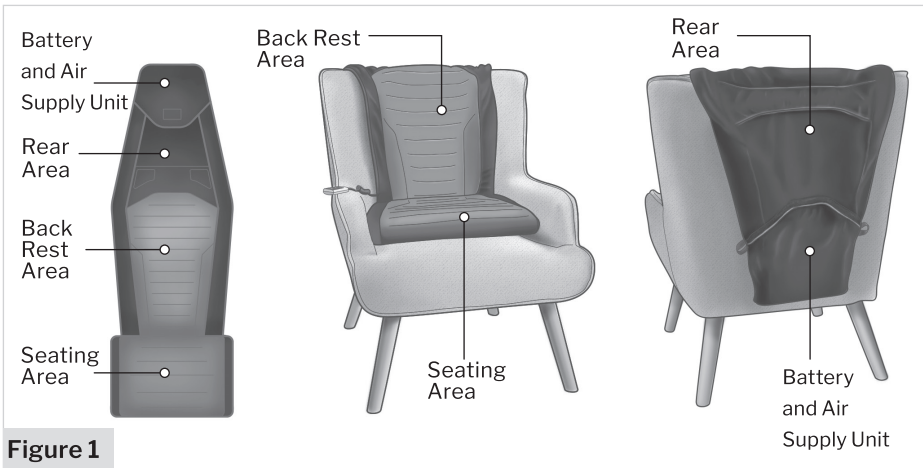

## Contents

- 1 **SitnStand** unit
- 1 **SitnStand** compatible case
- 1 Li-Ion 14.4VDC rechargeable battery
- 1 Wall battery charger with 1m cable and connector
- 1 User manual

## Warnings, Cautions and Notes

Three types of special messages appear in this User Manual:



**WARNING** indicates the possibility of injury to the patient or operator.



**CAUTION** indicates a condition that may lead to equipment malfunction.



**NOTE** provides other important information.



# Conditions for Use

## INTENDED USE

**The SitnStand** is a powered inflatable cushion intended for assisting patients suffering from mobility difficulties in rising from a seated position to standing, as well as in sitting down from a standing position. **The SitnStand** is intended to be used with any decent seating area.

**The SitnStand** is intended to be used in the homecare environment while performing daily activities, as well as in medical care facilities.

## INTENDED USERS

**The SitnStand** is intended to be used by elderly people and/or people with compromised mobility or difficulties.

**The SitnStand** is intended to be used by people with chronic or acute mobility difficulty.

## CONTRAINDICATIONS

Do not use **The SitnStand** while under the influence of narcotics or alcohol.

Do not use **The SitnStand** while holding a child or infant.

Do not use **The SitnStand** inside a vehicle.

Do not use **The SitnStand** without clothing.

In the case of Cognitive impairment, use **The SitnStand** only by a caregiver.

# SAFETY

## General Warnings and Cautions



**WARNING: DO NOT USE BEFORE READING AND UNDERSTANDING THIS MANUAL.**



**WARNING:** To avoid the potential for electrical shock, use only the designated charger provided with the device. Using any other charger may cause an electrical and/or electromagnetic hazard.



**WARNING:** To avoid the potential for electric shock, the power supply must be disconnected from the power mains prior to cleaning.



**WARNING:** To avoid the potential for electric shock, contact your seller or **Life Assistant Ltd.** when a malfunction occurs.



**WARNING:** Do not inflate under the bottom of a table or other item that interferes with the cushion inflation.



**NOTE:** The only user-serviceable components in the system are the battery and cushion jacket.



**CAUTION:** Changes or modifications not expressly approved by **Life Assistant Ltd** can affect the safety and effectiveness of the system, and will invalidate the system's warranty.













**CAUTION:** Do not operate with damaged cords or plugs. If damaged, please contact the company.



**CAUTION:** At the end of its useful life, the system and battery must be disposed of in accordance with local law and/or code concerning electrical and electronic equipment.

# LABELS AND SYMBOLS

SYMBOL	DESCRIPTION
	Consult instructions for use
	Date of Manufacture
	Special Requirements for Waste of Electrical and Electronic Equipment (WEEE Directive)
	Manufacturer
	Type B applied part
	Catalog Number
	Serial Number
	Keep dry
	Caution
	Information
	Compliance with Medical Device Regulation (EU) 2017/745 Compliance with Medical Device Directive (EU) 93/42/EEC

# USING THE SITNSTAND

## Setup Instructions

Setting up **the SitnStand** is performed by the user.

The setting up process consists of three steps:

Charging the battery for the first time

Placing **the SitnStand** on an appropriate seat

Connecting the battery

### A – CHARGING THE BATTERY FOR THE FIRST TIME-FIGURE 2

Charge the battery for at least 12 hours before use:

Remove the battery from the box

Plug in the battery charger into an electric wall socket

Connect the battery charger connector to the battery charging socket

When the green light is on, battery is fully charged

When red light is on, battery is not fully charged



**NOTE:** To prevent falling over any tangled cable, place the battery close to the charger.

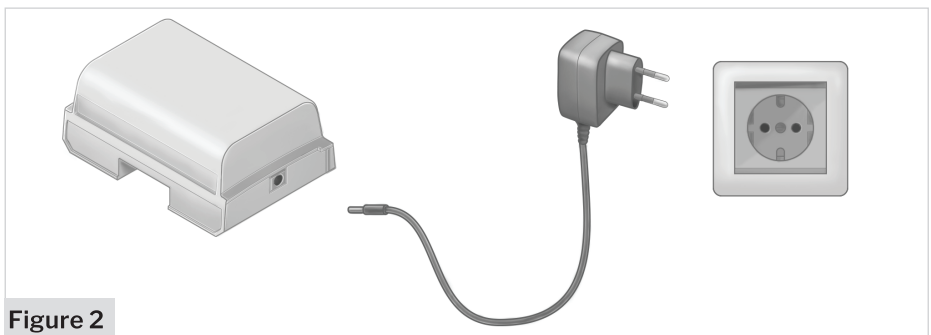

Figure 2

## **B – PLACING THE SITNSTAND ON A SUITABLE SEAT – FIGURE 3**

### Selection of an Appropriate Seat

When selecting the seat on which **the SitnStand** will be fitted, it is advisable to select a seat that is steady, stable and cannot be easily moved. An armchair is preferable.

An appropriate seat size for **the SitnStand** should be at least the minimum size of **the SitnStand** seating area in its deflated state, with at least one arm rest.



## Following the Appropriate Seat Selection

Place the seating area of **the SitnStand** directly onto the chair seat.

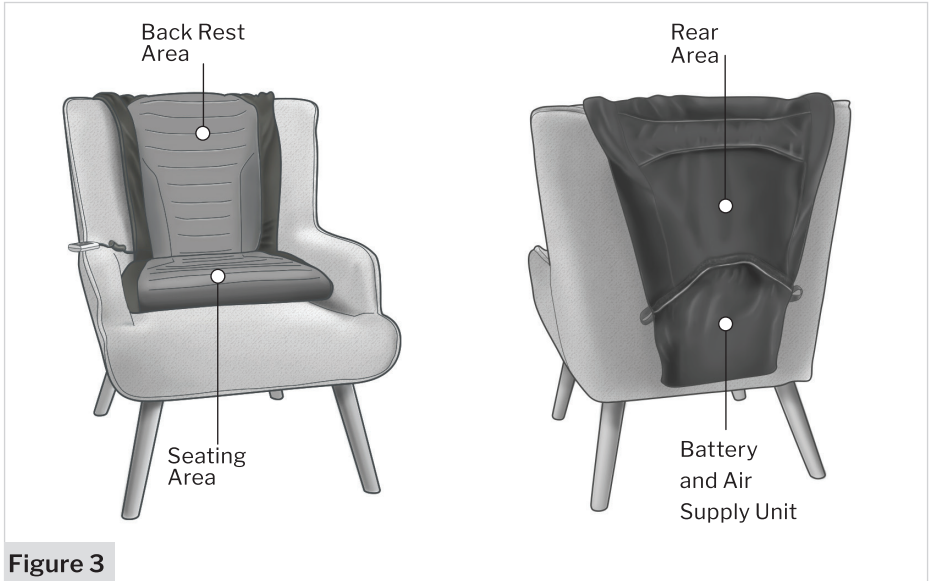

In most cases **the SitnStand** seat and backrest area should be placed in perfect alignment with the seating area of the seat itself as illustrated in **Figure 3**; however, in some cases location can be adjusted differently.

The rear area of **the SitnStand** should be laid over the rear area of the chair, as illustrated in **Figure 3**.

Placing a standard back pillow between **the SitnStand** backrest area and the chair backrest is an option.

## C – PLACING THE BATTERY IN ITS PLACE – FIGURE 4

Slide the charged battery into its place within the air supply unit, as illustrated in **Figure 4**.

*The SitnStand* is now in standby mode, and is ready for use.

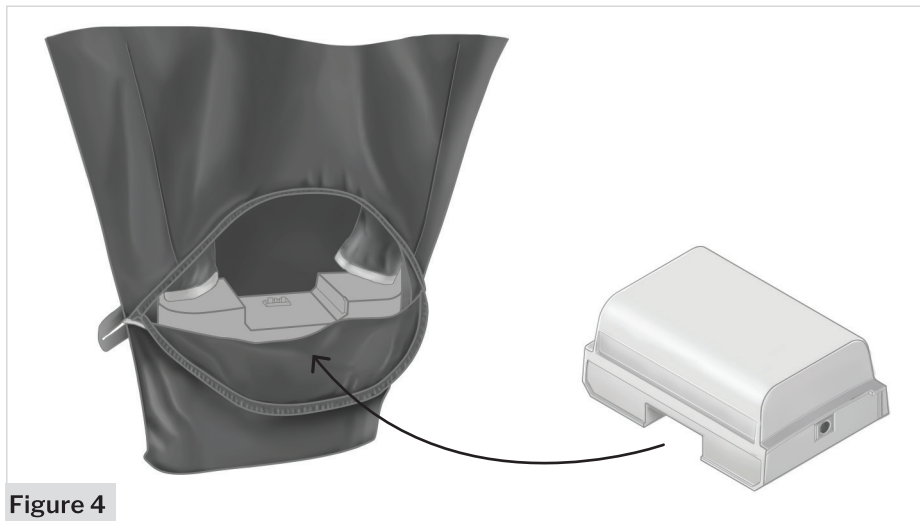

Figure 4

## Controller Indicator Modes - Figure 5

**Standby Mode** – the Green light flashes slowly (about one flash per second) – the **SitnStand** is now ready for use and is waiting for your action.

**Working Mode** – the Green light flashes quickly (about 5 times a second) – **The SitnStand** is operating (while in this mode, the buttons will not respond).

**Charge Battery** – the Orange light is on while the Standby/Working mode green light is also flashing as described in 1 or 2 above – indicating that the battery needs recharging.

**Charge Battery** – the Orange light is on and Standby/Working mode Green light is off – battery is depleted. In this case, the **SitnStand** cushion can only be deflated.

**Error** – the Red and Green lights flash quickly – **The SitnStand** has identified a system fault – See troubleshooting chapter.

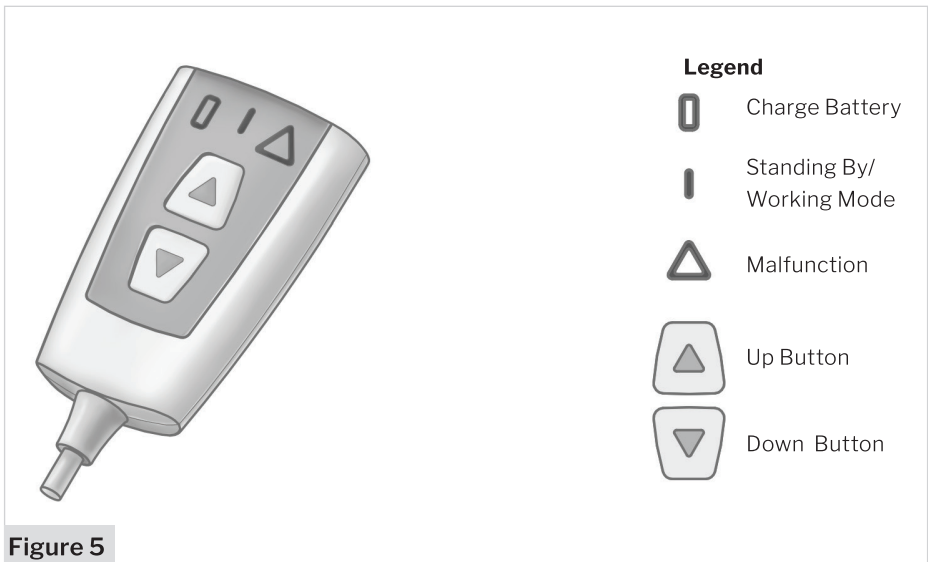

## Sitting Down

To sit down – inflate the cushion using the controller to 1,2,3 or 4 layers (whichever is most comfortable for you), then sit down on the pillow facing forward.

When you feel steady, start deflating the cushion by pressing on the Down Arrow button on the controller.

## Standing Up

To stand up – First, disconnect your upper-back from **the SitnStand** backrest area, and only then, start inflating the cushion one layer at a time by pressing the Up Arrow button on the controller.

**The SitnStand** has 4 layers: however, Inflation can be ended at any time when the level of elevation is sufficient.

Do not attempt to stand up before the layer is totally inflated and there is no sound from the air pump.

**The SitnStand** may remain inflated until the next time it is used for sitting down.

## Replacing the Battery – Figure 6

When the Charge Battery indicator turns Orange, battery should be charged.

Open the zipper covering the air supply unit and remove battery by sliding it towards you as illustrated in **Figure 6**.

The battery is connected by a magnet to the air supply unit.



**NOTE:** Don't remove the battery while **the SitnStand** is at "Working Mode" (see controller indicator modes)

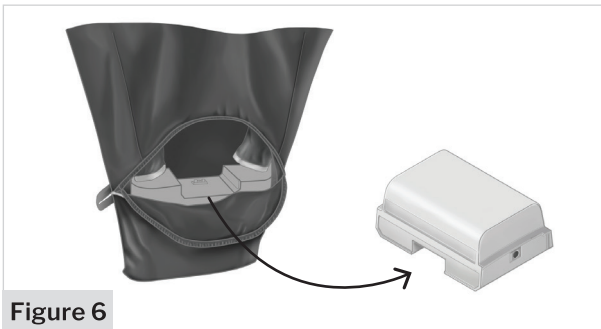

Figure 6

## Charging the Battery- Figure 7

Plug the battery charger into an electric wall socket.

Connect the battery charger connector to the battery charging socket.

When the Red light on the charger changes to Green, the battery is fully charged.

When the Red light is on, the battery is not fully charged.

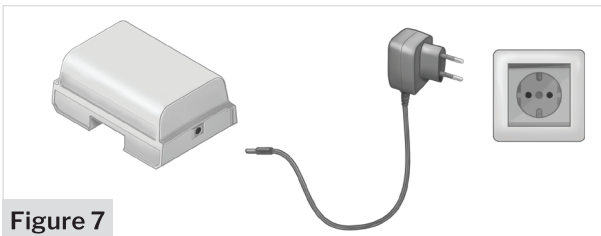

Figure 7

# MAINTENANCE

In order to maintain **the SitnStand** system, please note the following:

Keep **the SitnStand** away from dust or dirt

Use a soft dry brush to clean the fabric surfaces (e.g. seat area).

The cloth jacket of the seat may be removed and washed; return only after the jacket is completely dry

Do not iron the cloth jacket

Use a damp cloth to clean the plastic surfaces (e.g. air supply unit)

Do not use solvents or detergents to clean any part

Do not allow liquids near the system openings

Keep dry



**WARNING:** To avoid potential for electrical shock, the power supply must be disconnected from the power mains prior to cleaning.



**WARNING:** To avoid the potential for electric shock, contact your seller or **Life Assistant Ltd.** when a malfunction occurs.



**NOTE:** The only user-serviceable components in the system are the battery and cushion jacket.



**NOTE:** No portion of the system should be immersed in water or other fluids.



**NOTE:** Never spray or otherwise apply any cleaner fluid directly into the openings or seams of the system. Always apply the cleaner fluid to the cloth instead.

# TROUBLESHOOTING



Before addressing the troubleshooting table, please check and confirm the following:

1. The battery is attached to **the SitnStand**
2. The battery is charged. (low battery indicator is Off, standby/ready indicator is On)

## Basic Troubleshooting

When addressing a malfunction, as an initial action please follow **STEP 1** described at the table below. In case of unsolved malfunction follow **STEP 2**.

MALFUNCTION	STEP 1	STEP 2
Battery not charging	Charge the battery	Contact your seller or <b>Life Assistant Ltd.</b>
No light on the controller		
Product is not working when pressing the controller		
Does not deflate		
Does not inflate		
Air leaking	Contact your seller or <b>Life Assistant Ltd.</b>	
Red triangle light and the Green light on the controller are flashing	Press the two remote control buttons (up and down arrows) simultaneously for 10 seconds to reset system	Contact your seller or <b>Life Assistant Ltd.</b>

## To Obtain Information:

*Life Assistant LTD.*

8 Harod St. Afula, 1871208, ISRAEL

**email: [info@sitnstand.com](mailto:info@sitnstand.com)**

**web: [www.sitnstand.com](http://www.sitnstand.com)**



# OPERATING SPECIFICATIONS



**NOTE:** Unless otherwise indicated, all specifications are subject to change without notice. Specifications and test methods will be made available upon request.

## 1.1. Environmental

### 1.1.1. TRANSPORT AND STORAGE ENVIRONMENT

**Temperature range:** -25°C to +70°C (-13°F to 158°F)

---

**Relative humidity range:** Without relative humidity – 93%

### 1.1.2. OPERATION ENVIRONMENTAL CONDITIONS

**Temperature range:** +5°C to +40°C (41°F to 104°F)

---

**Relative humidity range:** 15% to 93%, with no condensation

---

**Atmospheric pressure:** 700 – 1060 hPa (10.15 - 15.37 psi)

---

**Transport altitude:** 0-2000 meters (0 - 6562 Feet)

## 1.2. Electrical

**Battery type:** Lithium-Ion Rechargeable, 14.4 V, 2.6 Ah

---

**Operation Voltage:** DC 14.4V @ 10A

---

**Charger Input:** 100 to 240VAC

---

**Charger output:** 16VDC, 0.5A (8W)

---

**Frequency:** 50 – 60Hz

---

**Battery life:** ~500 charging cycles / one year under warranty that the battery should be over 80% of its capacity

---



**CAUTION:** At the end of its useful life, the system and battery must be disposed of in accordance with local law and/or code concerning electrical and electronic equipment. Do not discard to standard trash bin.

## 1.3. Physical and Operational

**Seat footprint – Deflated:** 40 x 53 x 1 (cm) | (16 x 21 x 0.4 (In))

---

**Seat footprint – Inflated:** 40 x 48 x 25 (cm) | 16 x 19 x 10 (In)

---

**Carrying package dimensions:** 42 x 54 x 14 (cm) | 16.5 x 21 x 5.5 (In)

---

**Product Weight:** 4 kg | 6.6 Lbs.

---

**Max supported weight:** 120kg | 246.4 Lbs

---

**Nominal Operation time (inflate/deflate):** ~25 sec

---

**Control mechanism:** Up / down pushbutton   
 Green LED: system ready  
 Yellow LED: low bat.  
 Red LED: Error

---

**Air capacity:** ~1.7 L/Sec @ 1 AT pressure (~60 CFM @ 14 psi)

---

**Device lifetime:** ~10000 inflating cycles / 5 years

---

# LIMITED WARRANTY



**Life Assistant Ltd.** guarantees this product for a period of two years from the date of purchase.

The guarantee covers defects in materials and workmanship, comprising the system, assemblies, components and labor, but excluding battery and textile/fabric.

**Life Assistant Ltd.** guarantees the battery and the textile/fabric for one year from the date of purchase. The guarantee covers defects in materials and workmanship comprising the system, assemblies, components and labor.

The guarantee is not valid in the case of abnormal wear and tear, willful damage, neglect, misuse or unauthorized repair or alteration of the product, or any of its parts or accessories.

The following statements do not affect the consumer's statutory rights. This product is sold on the understanding that, in the event of any defect of manufacture or material appearing within two years of the date of receipt of this product, the defect will be amended free of charge on condition that evidence of date of ownership is provided. Such evidence may be an invoice, delivery note, etc. and, evidence that the defect is not attributable to accidental damage either in transit or otherwise, misuse or unauthorized repair or alteration.

**Product Serial Number:** \_\_\_\_\_

**Battery Serial Number:** \_\_\_\_\_

**Location of Purchase:** \_\_\_\_\_

**Date of Purchase:** \_\_\_\_\_

**Delivery Note/Invoice No.:** \_\_\_\_\_

# EMC STATEMENT

## Warnings



**WARNING:** Use of this equipment adjacent to or stacked with other equipment should be avoided as it may result in improper operation. If such use is necessary, this equipment and the other equipment should be observed to verify that they are operating normally.



**WARNING:** Use of accessories, transducers and cables other than those specified or provided by the manufacturer of this equipment, may result in increased electromagnetic emissions or decreased electromagnetic immunity of this equipment, resulting in improper operation.



**WARNING:** Portable RF communications equipment (including peripherals such as antenna cables and external antennas) should be used no closer than 30 cm (12 inches) to any part of **the SitnStand**, including cables specified by the manufacturer. Otherwise, degradation of the performance of this equipment may result.

## Electromagnetic Emissions

**SitnStand** is intended for use in the electromagnetic environment specified in the following tables. This is not a life-sustaining device.

The user and/or installer of the unit must ensure that it is used in such an environment.

<b>DECLARATION – ELECTROMAGNETIC EMISSIONS</b>		
<b>Emissions test</b>	<b>Compliance</b>	<b>Electromagnetic environment – guidance</b>
RF emissions CISPR 11	Group1 Class B	<b>The SitnStand</b> uses RF energy only for its internal function. Therefore, its RF emissions are very low and are not likely to cause any interference nearby electronic equipment.
Harmonic emissions IEC 61000-3-2	N/A	The <b>SitnStand</b> is suitable for use in all establishments, including domestic establishments and those directly connected to the public low voltage power supply network that supplies buildings used for domestic purposes..
Voltage Fluctuations And Flicker IEC 61000-3-3:2013	Complies	







# SitnStand

Portable Smart Rising Seats

Exclusively distributed by



1300 133 120 | [aidacare.com.au](http://aidacare.com.au)

© 2022 **Life Assistant LTD**, all rights reserved.

No part of this manual may be reproduced in any form  
without the written permission of **Life Assistant Ltd.**