

Invacare General Purpose Sling

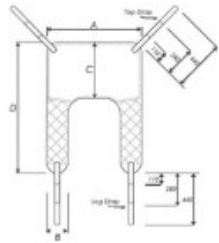

General Purpose Sling

	S	M	L	XL
A	850	920	1190	1270
B	230	220	260	260
C	490	530	650	730
D	1180	1240	1360	1520
CODE	Fabric 17105	17041	17043	17204
	Mesh 17123	17124	17125	N/A



- This sling provides easy fitting and good support for patients with some upper body control
 - **Supports the Whole Body:** Including the shoulders, ensuring comprehensive comfort and relaxation.
 - **Suitable for Those with Good Head Control:** Providing adequate support for individuals capable of maintaining head control.
 - **Can Be Used for Transfers:** From a lying position, lifting from the floor, and seated to seated transfers, offering versatility in caregiving scenarios.

Warranty Information

- 1 Year



ndis

Item Code:

05_123603164_0105_1_2

Sling – Composite:

05_421_0105_1_2

Click [here](#) for more information

Compliance

AS/NZS ISO 10535:2011

Code	Display Name	Safe Working Load	Material
LSS373400	Invacare General Purpose Poly - Small	205 kg	Polyester
LSS373000	Invacare General Purpose Poly - Medium	205 kg	Polyester
LSS373205	Invacare General Purpose Poly - Large	300 kg	Polyester
LSS374305	Invacare General Purpose Poly - Extra Large	300 kg	Polyester
LSS373495	Invacare General Purpose Mesh - Small	205 kg	Mesh
LSS373500	Invacare General Purpose Mesh - Medium	205 kg	Mesh

Code	Display Name	Safe Working Load	Material
LSS373505	Invacare General Purpose Mesh - Large	300 kg	Mesh